

Butterfly valve for abrasive fluids

MENTO

Your link to improved performance

+47 48 11 03 00

24h +47 90 19 51 55

post@mento.no

www.mento.no

PD (PowDers) series is a rubber seated valve created for bulk handling, in which the disc geometry is studied to permit low torque open/close and reduce heavily wear of the seats over time.

This helps increasing lifetime of the valves and in the meantime permit use of smaller actuators, with considerable economical and space advantage

BUTTERFLY VALVES Rubber seated - PD Series

type	DN	Pmax	vacuum	Flanges
Wafer, Lug, Double Flange	DN80-500	10bar	Y	PN 6-10-16 • A150
Wafer, Lug, Double Flange	DN600	6bar	Y	PN 6-10-16 • A150
Wafer, Lug	DN700-800	6bar	Y	PN 10-16 • A150

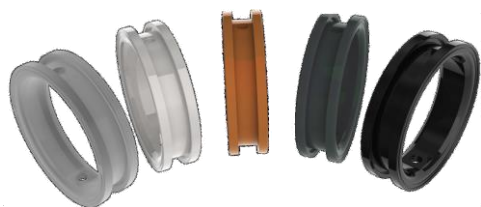

Rubber seats range include:

NBR Tmax 90C°

Carboxide Tmax 90C°

Polyurethane Tmax 90C°

Natural rubber Tmax 80C°

FKM Tmax 150C°

Valve bodies materials can be :

Aluminium (wafer only),

Ductile iron,

WCB steel,

A316 Stainless steel,

Alubronze,

Special Alloys on request

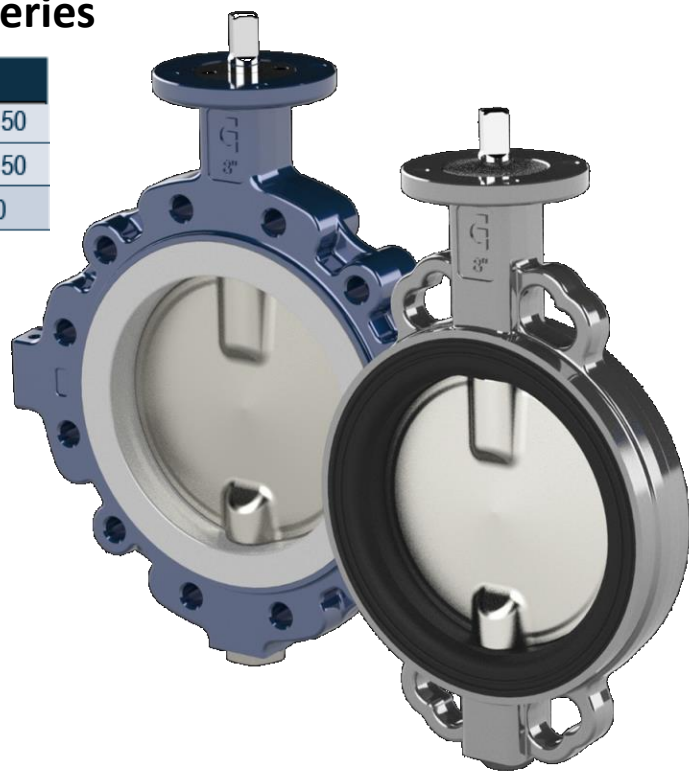

Discs range include:

Ductile iron GS40

Chenisil coated ductile iron

Aisi 316

Chenisil coated AISI316

Halar coated AISI 316

Alubronze

Special Alloys on request

Application & material

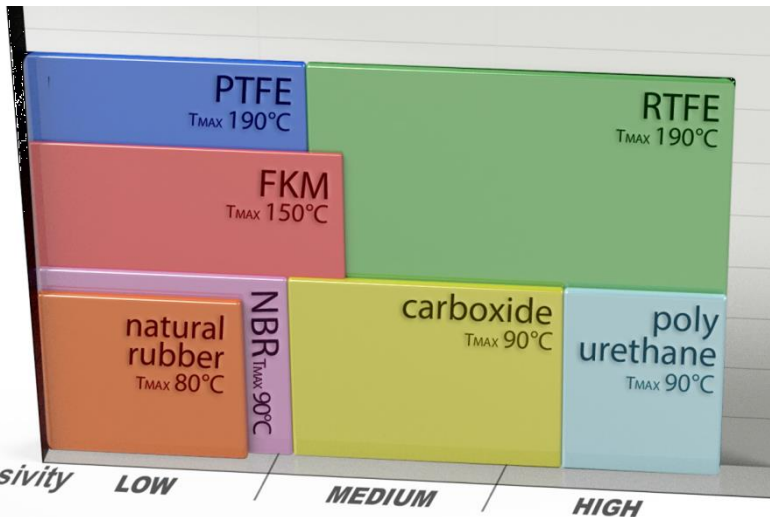

*The above graphic is indicative only.
Any application to be agreed with our technical department*

Typical applications

Alumina	Metallurgical coke
Bentonite	Mineral black
Borax	Mortar mix
Calcium	Pellet silicon dioxide
Cement	Petroleum coke
Ceramic dust	Plastic Pellet
Chopped fiberglass	Polyester pellets
Clay	Polyethylene powder
Coal	Polypropylene pellets
Coke	Polystyrene pellets
Dolomite	Pvc compound
Dry ash	Pvc powder
Fiberglass	Resin
Fine dry ceramic	Salt crystals
Fine salt	Sand
Graphite	Silica sand
Gypsum	Silicates
Iron powder	Talc
Lime	Tobacco
Limestone	Urea prills
Magnesite	Vermiculite
Metal powder	Zinc powder



Actuations & options

PNEUMATIC

Pneumatic actuators are based on rack and pinion technology, very compact and resistant. Available with different options for any kind of industrial applications and ambient conditions. With all types of accessories. Standard/special executions.

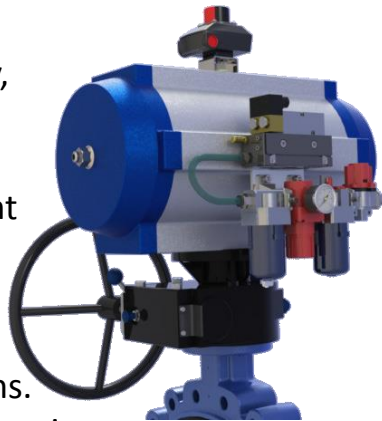

HIGH PERFORMANCE

specifically designed for high demanding applications where the valve performance is critical. Available in different materials and ratings. The Fire safe version is Fire tested to API 607-6th ed.



ELECTRIC

Electric actuators are available in different versions for ON-OFF and/or regulating applications. Electric actuators also include Atex versions as well a wide range of customizations.



PTFE SEATED

available in a wide range of materials combinations, and specifically designed for the chemical industry and heavy duty applications.



HYDRAULIC

Gibson's own manufactured hydraulic actuators (ARES series) are designed to fulfill the specific requirement in industrial applications: compact design and high performance are the main characteristics of this product range



RUBBER SEATED

designed to fit in industrial applications from powder conveyance to marine and petrochemical requirements.

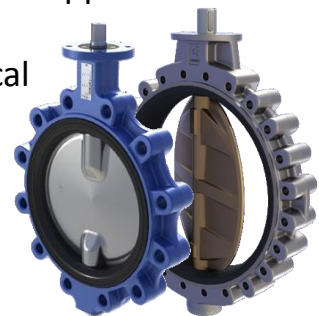

DAMPER VALVES

fully manufactured and designed according to customer requirements, mainly used with high temperature combined with low pressure applications.

